

Power Strap Clamps (Adjustable Rocker Clamps)

Use Power Strap Clamps when clamping height variations exceed range of Rocker Clamps.

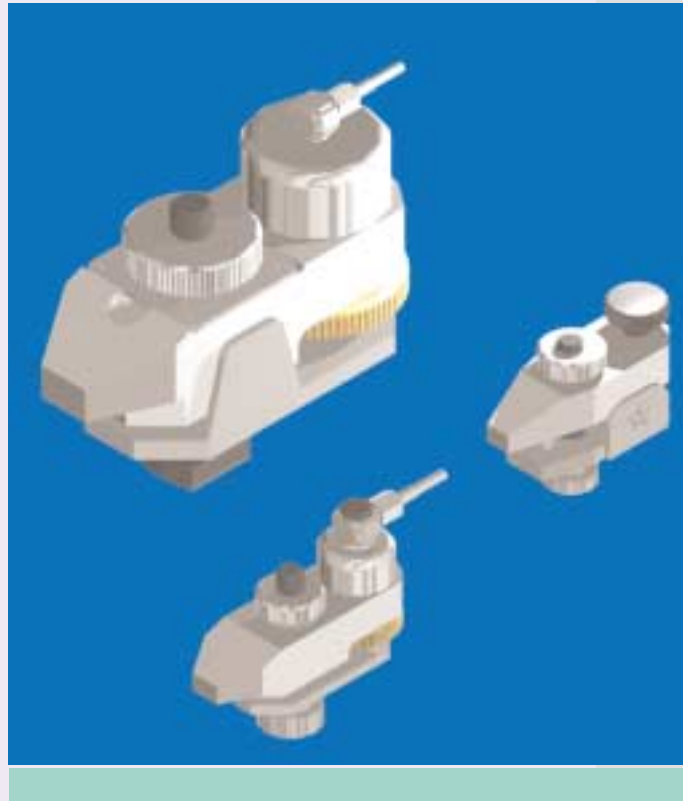

**A leading manufacturer
of equipment for
Quick Die Change and
Quick Mold Change**

Power Strap Clamps - Hydraulic

Selected Models:

Model-662

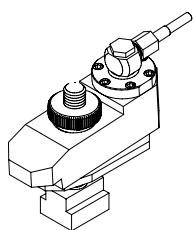

Model-829

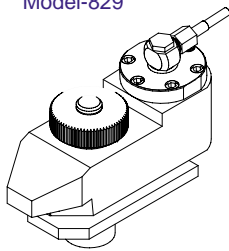

Model-836

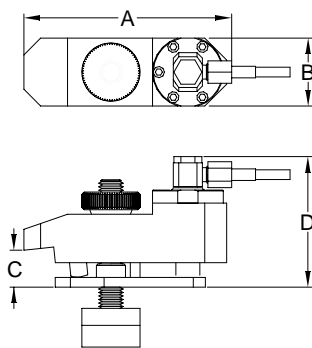
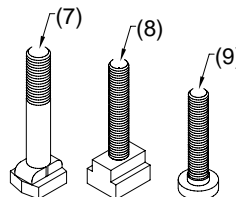
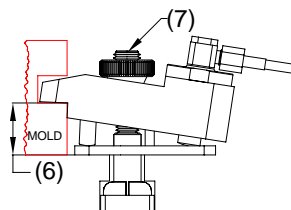
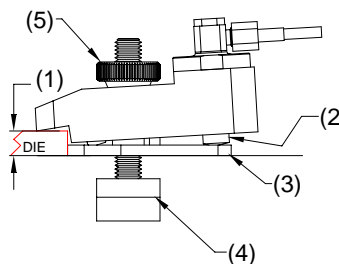
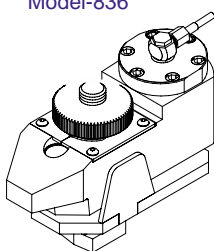

Model	662	829	836
Clamping force	3,500	8,000	17,000
Stud Thd Size	5/8-11	3/4-10	1"-8
Dim A	5.23	7.26	9.45
Dim B	1.75	2.50	4.00
Dim C - Min	.75	.81	1.25
Dim C - Max	1.50	2.06	2.47
Dim D*	3.37	4.74	5.97
Weight in lbs.	5	13	32

*Clamp at horizontal position

Application Notes:

Model-662 is shown clamping at minimum clamping height (1). Down facing hydraulic piston (2) is extended and stalled against underplate (3). A square T-nut (4) is secured in a T-slot (not shown). Before applying hydraulic pressure the height adjustment knob (5) was manually turned until the clamp rocker touched the clamping surface.

Model-662 is shown clamped at maximum clamp height (6). Note that the stud (7) is barely visible since the clamp was adjusted to its maximum clamping height before hydraulic pressure was applied.

Power strap clamps are available with T-slot bolt (7). Fully threaded stud and T-nut (8) and fully threaded stud and round T-nut (9) which includes an anti-rotation feature.

Power Strap Clamps - Hydra Mechanical

Selected Models:

Model-660L

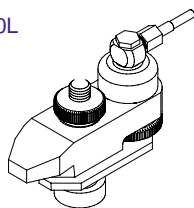

Model-661L

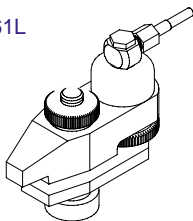

Model-825L

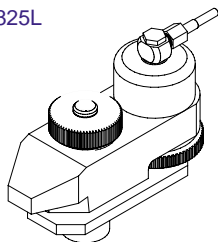

Model-835L

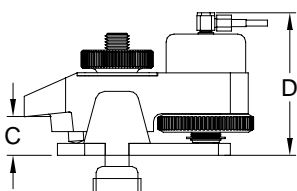
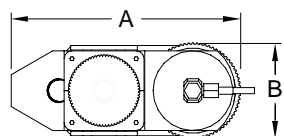
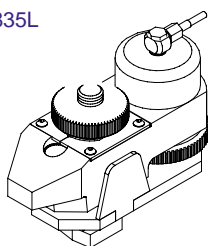

Model	660L	661L	825L	835L
Clamping force	3,500	3,500	8,000	17,000
Stud Thd Size	5/8-11	5/8-11	3/4-10	1"-8
Dim A	5.56	5.23	7.42	9.60
Dim B	1.75	1.75	2.50	4.00
Dim C - Min	.50	.75	.81	1.25
Dim C - Max	1.50	1.45	2.06	2.47
Dim D*	3.62	3.75	4.74	5.97
Weight in lbs.	5	5	13	32

*Clamp at horizontal position

Application Notes:

The clamping height adjustments and use of hydraulic pressure is the same as described above.

In addition a Locking Ring (1) (means of mechanically locking the clamp) has been added. The upper illustration shows the clamp pressurized. Note gap (2) between clamp body and locking ring. In the lower illustration the locking ring has been firmly turned against the clamp body (3) This is done without tools. At this point the hydraulic pressure source is disconnected. Hydraulic pressure must be re-connected before the locking ring can be turned away from the clamp body. When hydraulic pressure is relieved the clamp opens by spring pressure. The height adjustment knob is rotated to elevate the clamp rocker away from the die or mold as necessary.

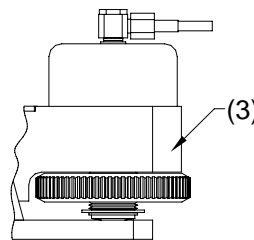
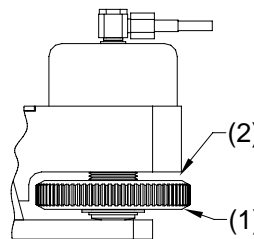

Strap Clamps - Mechanical

Selected Models:

Model-261

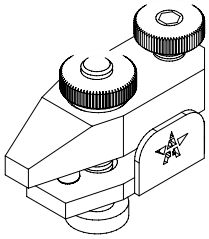

Model-265

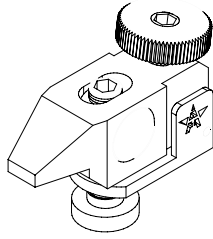

Model-266

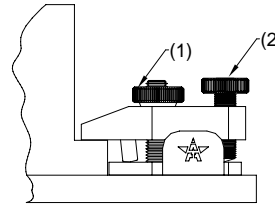
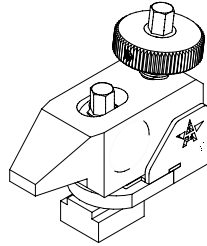

Application Notes:

The Model-261 is moved into position and adjusted for clamping height by turning the clamp adjustment knob (1). The thumbwheel (2) is used to quickly apply a manual clamping pre-load. A wrench is then used to tighten the clamp to the rated clamping force.

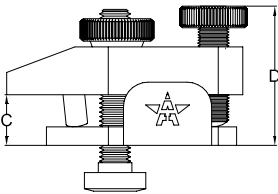
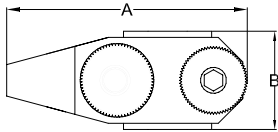

Model	261	265	266
Clamping force	4,000	3,000	8,000
Stud Thd Size	5/8-11	5/8-11	3/4-10
Dim A	4.91	4.25	5.50
Dim B	2.00	1.50	2.05
Dim C - Min	.81	**	**
Dim C - Max	1.25	**	**
Dim D*	2.83	2.88	4.14
Weight in lbs.	5	3	12

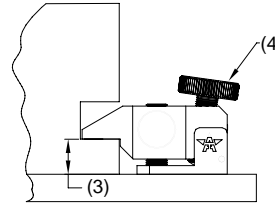

The Model-265 and Model-266 are available in three standard nominal clamping heights (3) as shown in table below. Clamping surfaces +/- 3/16" from nominal can be clamped. The thumbwheel (4) is used to quickly pre-load the clamp. A wrench is then used to tighten the clamp to the rated clamping force.

Dash	Nominal Clamping Height	
	265	266
-1	.53	.75
-3	.78	1.12
-5	1.03	1.50

*Clamp at horizontal position

** Select -1, -3, -5. See table at right.

Die/Mold Clamping Summary

Power Strap Clamps - Hydraulic

1. Move clamp to the tool and adjust for clamping height by rotating adjustment knob.
2. Actuate hydraulic pressure.
3. To un-clamp turn off hydraulic pressure and pull clamp away.

Power Strap Clamps - Hydra Mechanical

1. Move clamp to the tool and adjust for clamping height by rotating adjustment knob.
2. Actuate hydraulic pressure.
3. Set mechanical lock by rotating locking ring firmly against clamp body.
4. Turn off hydraulic pressure.
5. To un-clamp, reapply hydraulic pressure and rotate locking ring away from clamp body.
6. Turn off hydraulic pressure, loosen adjustment knob slightly and pull clamp away.

Strap Clamps - Mechanical

1. Move clamps to the tool.
2. Turn thumbscrew manually to apply firm clamp pre-load.
3. Use a wrench to apply full clamping force.
4. To un-clamp, use a wrench to open clamp and pull it away.

Other Clamp Styles

Rocker Clamps

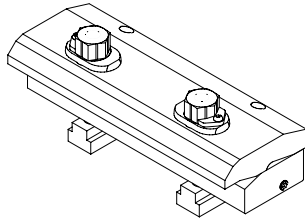

Model-128

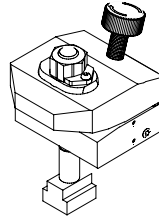

Model-428L

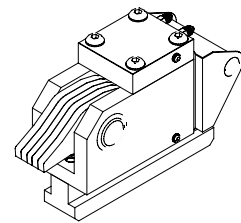

Model-979

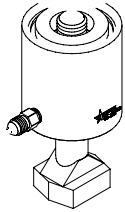

Model-200

Hydraulic Nuts

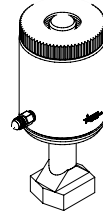

Model-201L

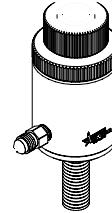

Model-210L

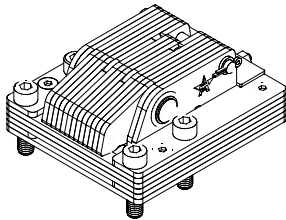

Model-751

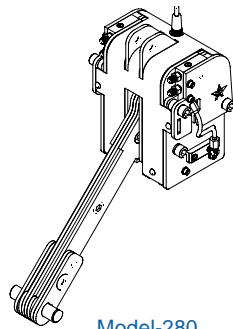

Model-280

Multi Articulating Clamps

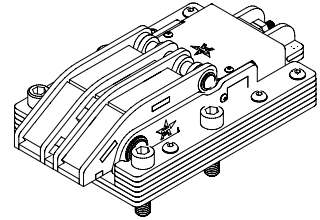

Model-750

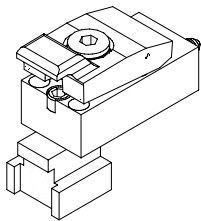

Model-221B

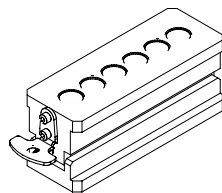

Model-928

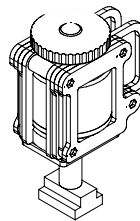

Model-203LH

Specialty Clamps

Other Hydraulic Clamp Brochures:

Rocker Clamps • Hydraulic Nuts • Specialty Clamps • Multi-Articulating Clamps

Related Brochures:

Die Lifters • Bolster Extensions • Mechanical Die Lifters • Power and Control Modules



American Aerostar Corporation

25014 Avenue Kearny

Valencia, CA, USA 91355-1253

Phone: 800-780-9850 or 661-257-6600 Fax: 661-257-6609

E-mail: sales@astar.com Web Site: www.astar.com

Represented by:

Products depicted in this brochure are proprietary intellectual property of American Aerostar Corporation and in addition may be protected by U.S. Patent(s) or patents pending. Specifications subject to change.

Catalog PS0402